



THE CAMPAIGN FOR GLOBAL GROWERS NETWORK



GLOBAL  GROWERS

Global Growers Network (GGN) is seeking \$1.5 million in philanthropic support for the purchase of our new flagship farm. Located on 23 acres of prime farmland in Rockdale County, the new farm will be home to 15 distinct farm businesses and will serve as a local model for cooperative farming and ecological land management.

ABOUT GLOBAL GROWERS NETWORK

In the spring of 2010, a group of families from Burundi, Rwanda, Congo, and Tanzania broke ground on a small plot of land in Decatur, GA. This group of resettled refugees had a strong desire to reclaim their agricultural heritage to support the well-being of their families during their transition to a new home. Their plot of land came to be known as Umurima, which translates into “farm” in Kirundi. Umurima would become the inspiration for several hundred more families and organizational partners that would soon form GGN.

OUR WORK AND IMPACT

Global Growers Network partners with people from diverse cultures who grow fresh food for their families and for local marketplaces. Together, we build and sustain networks of growers, land, resources, and markets. We believe that smallholder farmers will play a leading role in improving outcomes related to food security, community vitality, and biodiversity.

At a critical time, we are creating a more equitable food system that is driven by cultural diversity, inclusive economies, and regenerative agriculture practices.

As a result of our work, GGN farmers are increasing their economic self-sufficiency, increasing availability of fresh food in low-income neighborhoods, preserving and sharing important cultural traditions, and improving the biodiversity and ecological health of threatened peri-urban spaces.



“Farming is something I have always known; my father and my father’s father were farmers. Having my farm means I can use my skills to feed my family and earn income. I can control what happens on my land. The land is my connection to my family and to my food. The land is my life.”

Steven Than Ceu, GGN grower

GLOBAL GROWERS FARM CAMPAIGN: THE JOURNEY TO LAND OWNERSHIP

More than 50% of resettled refugees come from agrarian backgrounds and are expert food producers. However, once in the US, most new Americans face critical barriers to accessing growing land and the opportunity to sow their talent. GGN creates the conditions for these talented food producers to thrive by connecting them to the land and agricultural resources they need to grow fresh, culturally relevant food for their families and to sell at local marketplaces.

GGN prioritizes communities experiencing barriers to land access due to historic or current oppression, including BIPOC growers and new Americans. For the growers in our network, this land justice initiative is vital to establishing food sovereignty and financial stability.

Today, more than 300 new American families grow fresh food across GGN's network of eight farm and garden sites in Metro Atlanta. Our network consists primarily of

Community Growers, who primarily grow food for their families, as well as a growing number of Commercial Farmers, who primarily grow to sell to local markets.

From 2010 to 2019, GGN operated the Bamboo Creek Farm. There, five new American families operated small farm businesses through a cooperative farming model. The farmers shared common agricultural infrastructure to reduce capital costs and sold to local markets through GGN's sales program.

Although operations were halted in 2019 after a devastating flood, a successful proof-of-concept model was established.

In 2020, GGN accelerated the search for a new farm site to meet the growing demand for land among aspiring commercial farmers across GGN's network and to build on the success of the model established at Bamboo Creek.

AN INNOVATIVE PARTNERSHIP BRINGS OUR DREAM TO LIFE

Following a thoughtful and thorough land search, GGN found our dream farm, a beautiful 23-acre property in Rockdale County. Through an innovative partnership with The Conservation Fund's Working Farms Fund Program, GGN will own this land outright in three years. The Fund purchased the property and immediately entered into a lease-to-own agreement with GGN. This pathway to land ownership with a conservation buyer is a new model being piloted in Georgia, with plans to expand nationwide. GGN is among the first to pursue this pathway.

Global Growers Network acknowledges the Muscogee (Creek) Nation as the original and rightful custodians of the land our new farm is located on.

Although the international growers in our network cannot grow food in their homelands, this land provides them a link to their cultural traditions.



SEEDING THE NEXT ERA FOR GLOBAL GROWERS NETWORK

Our new farm will provide a permanent home and new opportunities to farmers that have endured transience and limited opportunity. The farm will:

- Establish a cooperative system that will reduce costs for talented farmers who face barriers to accessing land and capital
- Preserve and share the multicultural traditions and foodways of our diverse grower network and metro Atlanta community
- Support growers in producing fresh food for local consumption and developing new markets for their farm products
- Create a vibrant and inclusive agritourism destination and community gathering space that celebrates local agriculture and global food cultures.



The needs are great, but the impact will be greater!

HIGHER GROUND PROJECT BUDGET (2021-2024)

Budget Item	Amount	Description
Land Acquisition*	\$551,720	23-acre farm with house and agricultural infrastructure, located in Rockdale County (30 minutes from Clarkston); Costs incurred 2021-2024
Site Improvements	\$431,206	Farm renovations and additions to develop certified organic co-farming operation and community farm destination; Costs incurred 2021-2023
Social Enterprise Investments	\$281,000	Working capital and specialized equipment to re-launch GGN sales enterprise and build new farm-based earned income streams; Costs incurred 2021-24
Program Capacity Building	\$250,000	Scale and integrate existing programs as we introduce new grower pathways and grower services associated with the new farm site; Costs incurred 2021-2023
Project Total	\$1,513,926	

*In March 2021, GGN entered into a lease-to-own contract with The Conservation Fund's Working Farms Fund Program with the following financial arrangements to begin on 4/1/21.

The total cost of the land acquisition will be discounted by nearly \$300,000 from the 2021 purchase price of \$820,000 as the result of a planned conservation easement to be placed in the property in 2022-2023, as facilitated by The Conservation Fund.

GROWER PROFILE

LAL THANG

GROWER JOURNEY

Lal joined GGN in 2012 as a community grower at Decatur's Kitchen Garden on a small, 600 square foot plot. With greater ambitions, he requested additional land at Bamboo Creek Farm, where he started with a quarter acre. Over the course of several years, Lal steadily expanded his farm plot until he was managing just over 1 acre of land, as he steadily increased his direct sales to community members and aggregated sales to the GGN sales enterprise.

After 3 years of farming part-time, Lal began earning enough to leave his job at a poultry factory to become a full-time farmer. Lal specialized in growing Burmese and south Asian specialty crops, along with southern American staples, until his operation was suddenly halted by the devastating flood that impacted all Bamboo Creek Farm enterprises in 2019. Lal returned to work at the poultry factory, but he is eager to continue to grow his farm business and hopes to eventually have 3-5 acres in production, with access to a robust marketplace.

WHAT LAL IS KNOWN FOR

fastidious organization, experimenting with new crop varieties, an amazing hat collection, and the bamboo swing set he built next to his farm plot for his children.



Country of Origin:

Myanmar (Burma)

Language:

Hahka Chin

Grower Network

Member Since:

2012

Top Crops:

pumpkin and roselle leaves



www.globalgrowers.org | info@globalgrowers.org

If you're interested in investing in Higher Ground: The Campaign for Global Growers Network, please contact Robin Chanin at robin@globalgrowers.org.

Thank you!



PREPARED BY PURPOSE POSSIBLE

LEGEND

A. Circulation

- A1 - Entry Gateway
- A2 - Farm Service Road
- A3 - Arrival at Round-about
- A4 - Primary Parking for Events + Farmer Parking
- A5 - Gateway into Farm Interior
- A6 - Ag-Meander (Pedestrian)

B. Arrival Center + Central Barn + Welcome Building

C. Events + Gathering Areas

- C1 - Farm Center Area
- C2 - Event Barn
- C2A - Staging Barn
- C2B - Main Event Space
- C3 - Farm-to-Table Green
- C4 - Pond Overlook Green + Pavilion
- C5 - Central Event Venue Area
- C6 - Gathering by the Lake
- C7 - Outdoor Classrooms

D. Farm Operations Center

- D1 - Equipment + Maintenance Barn
- D2 - Tool + Storage Shed

E. Greenhouse + Composting Center

- E1 - Primary Post Harvest Center
- E2 - Greenhouses
- E3 - Propagation + Potting
- E4 - Composting Center

F. Existing House + Lot

G. Orchard

H. Farm Accessory Building

I. Fields + Gardens

- I1 - Silvopasture
- I2 - Production Fields
- I3 - Showcase + Welcome Gardens
- I4 - Production Fields
- I5 - Production Fields

J. Natural Habitats

- J1 - Lake Shore Riparian Habitat
- J2 - Intermittent Stream + Woodland
- J3 - Pond Habitat
- J4 - Property Perimeter Habitats

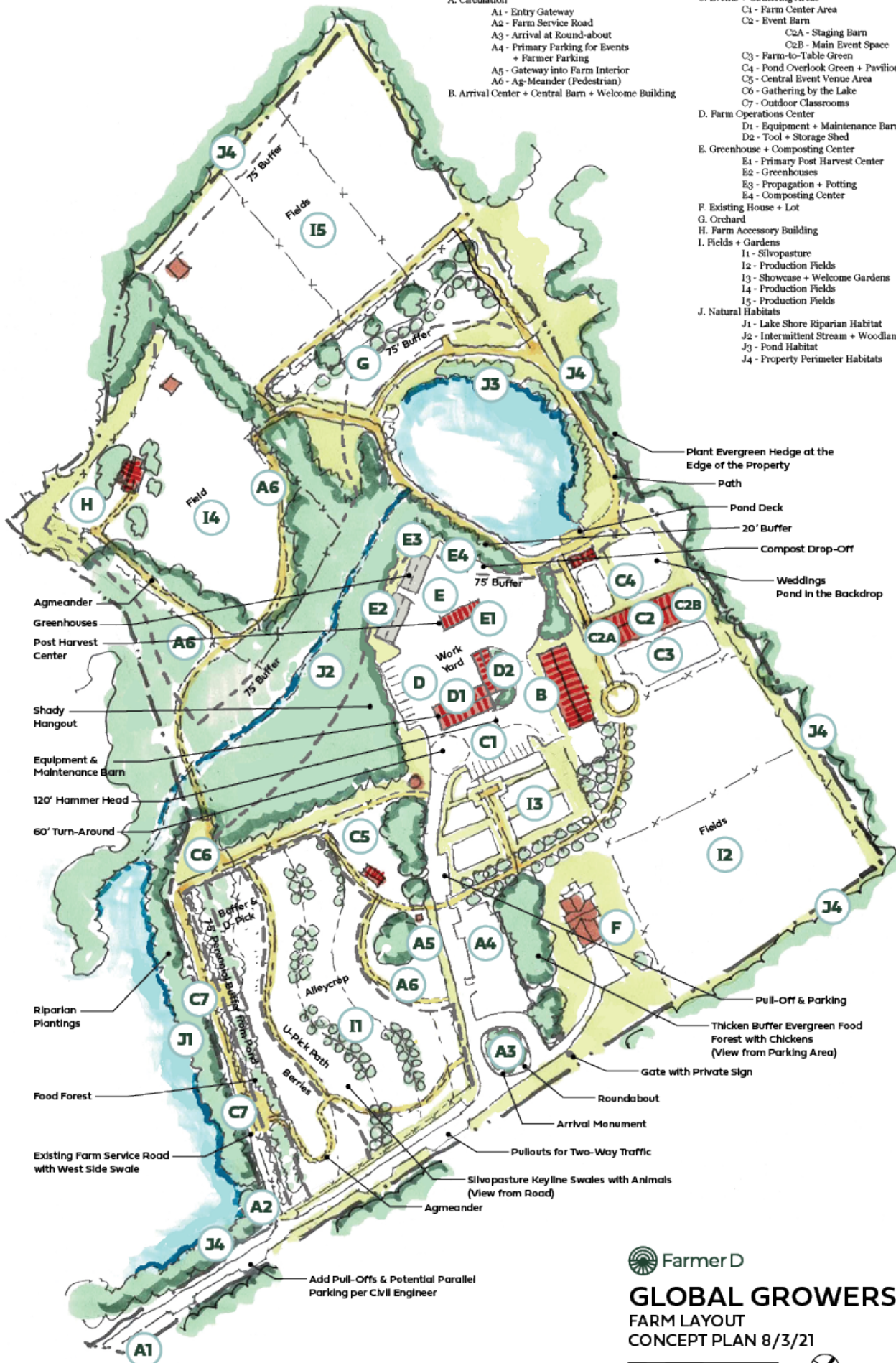

Farmer D
GLOBAL GROWERS
 FARM LAYOUT
 CONCEPT PLAN 8/3/21





**Higher Ground: The Campaign for
Global Growers Network
2021-2022**

Naming Opportunities and Ways to Support

As GGN enters its second decade and embarks on an exciting land acquisition and farm improvement initiative, we invite you to invest in this campaign. Our new 23-acre farm offers many opportunities for the organization to publicly thank our leadership donors by recognizing their enduring commitment to GGN through buildings, offices and outdoor space named for the donors or loved ones of their choice.

Fields and Gardens <i>(The fields and gardens are a priority project, and work is already underway)</i>	\$150,000
Welcome Garden	\$100,000
Agroforestry Field	\$75,000
Organic Vegetable Fields (6)	\$50,000
Orchard	\$30,000
Farm Operations Center <i>(The Farm Ops Center is a priority project, and work is already underway)</i>	\$150,000
Farm Wash and Pack (Postharvest) Station with Vegetable Cold Storage Area	\$100,000
Greenhouses (2)	\$50,000
Outdoor Classroom	\$30,000
Equipment and Tool Sheds (2)	\$20,000
Composting Center	\$10,000
Community Event Space	\$150,000
Large Event Pavilion	\$100,000
Small Pond Pavilion	\$75,000



Higher Ground: The Campaign for
Global Growers Network
2021-2022

Event Green	\$50,000
Catering and Processing Kitchen	\$50,000
Conference Room	\$30,000
Welcome Barn	\$150,000
Arbor Road and Farm Entrance	\$100,000
Community Meeting Space	\$75,000
Seed & Resource Library	\$50,000
Farmer Lounge	\$30,000
Farm Store	\$20,000
Farm Office	\$10,000
The Crop Circle- We also welcome your support for the farm's greatest needs and appreciate our Crop Circle members who make a campaign gift of \$5,000 and above	\$5,000